

Amazon Alexa mydlink Smart Smart Plug Setup Guide

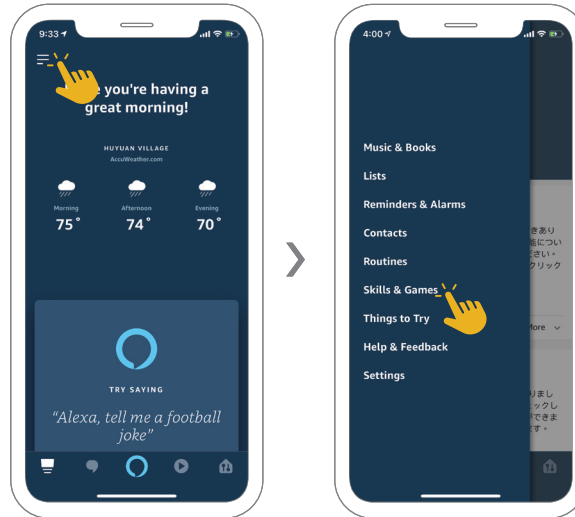

1 Tap ☰ on the Amazon Alexa app's home screen, then on **Skills & Games**.



2 Search for **"mydlink Smart"**. Tap on the result.

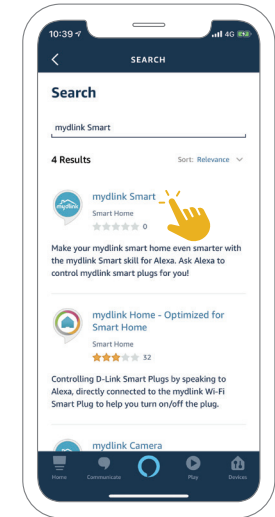

1. Turn your smart plug on.

"Alexa, turn on <plug name>."

2. Turn your smart plug off.

"Alexa, turn off <plug name>."

3 Tap **ENABLE TO USE**. Sign in with your mydlink account.

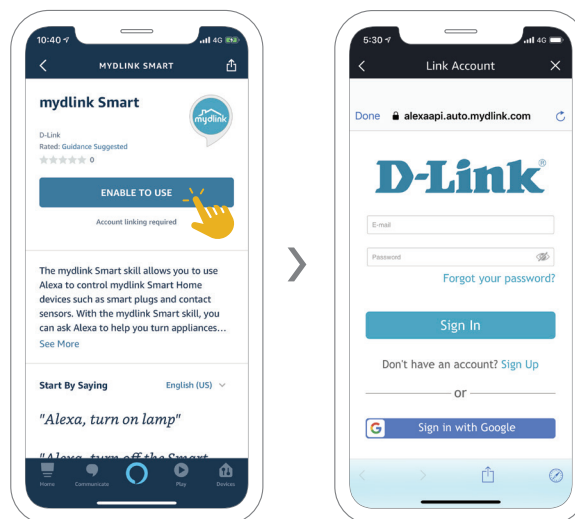

4 Tap **X** then tap **DISCOVER DEVICES** and follow the on-screen instructions to complete the setup.

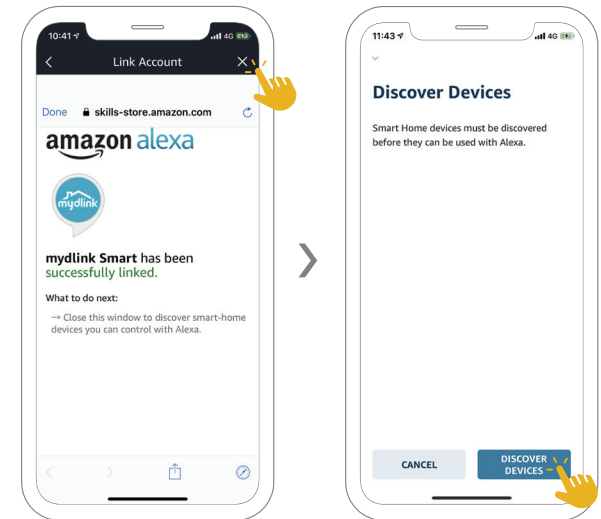

Note: The screenshots may be different depending on your mobile device's OS version. The following steps show the iOS interface. If you are using an Android device, the appearance may be different from that of the screenshots, but the process is the same.



The Google Assistant mydlink Smart Smart Plug Setup Guide



1 Tap and search for “mydlink Smart”. Tap on the result.

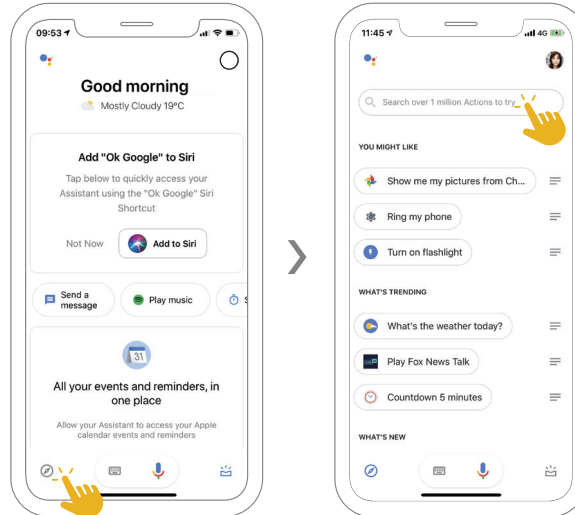

2 Tap **SET UP** then tap .

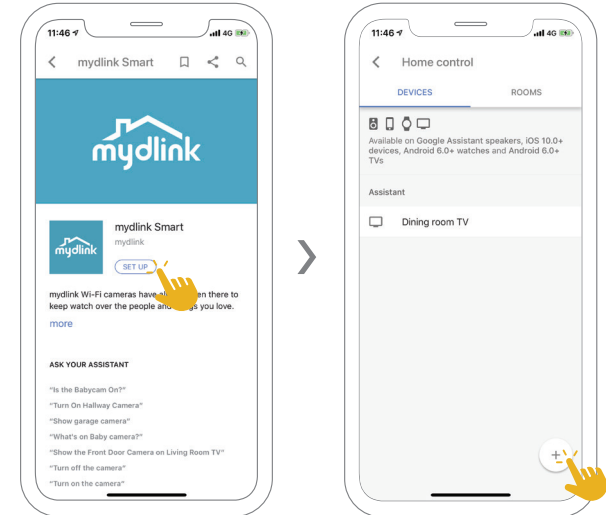

1. Turn your smart plug on.

OK Google, turn on <plug name>.

2. Turn your smart plug off.

OK Google, turn off <plug name>.

3 Search for “mydlink Smart”. Tap on the result. Sign in with your mydlink account.

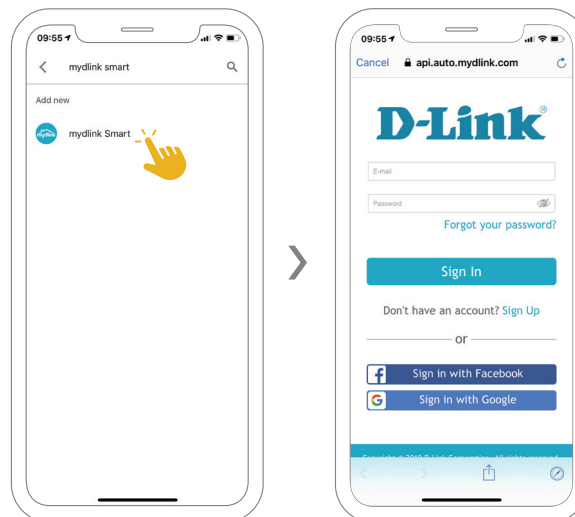

4 Tap to assign your device to a room. Tap **Done** to complete setup.

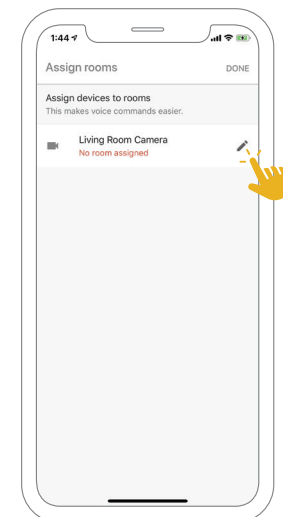

Note: The screenshots may be different depending on your mobile device's OS version. The following steps show the iOS interface. If you are using an Android device, the appearance may be different from that of the screenshots, but the process is the same.